



LED Bollard



JD-L1021

- The lamp body is made of 6063 aluminum alloy tube and high-strength die-casting aluminum material, and the surface is anti-aging electrostatic sprayed.
- The light-transmitting cover adopts imported PC material, anti-aging and anti-ultraviolet.
- The protection grade can reach IP65, which is superior to traditional lawn lamps.
- The light source is scattered to the surroundings, embellishment and strong practicability in the lawn, not only to achieve a beautiful effect but also to guide the way.
- Installation and disassembly are convenient, safe and environmentally friendly.

www.classicledlight.com
@sclassicliting.com

配光曲线图 Light Distribution Curve

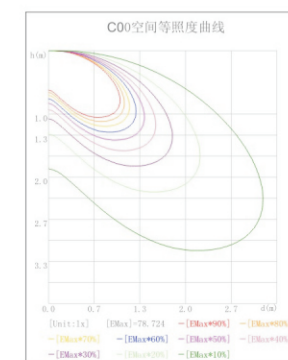
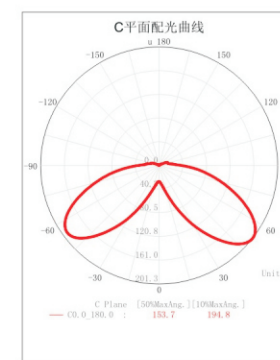

Product Information

Model No.	Watt	Lumen	Temperature	Steering	Rated voltage	Color	Mount
JD-L1021	18W	800-850lm	3000-6000K	Active Night/ Normal	220-240VAC 50/60Hz	Black	Mounting plate
Applications (for outdoor use): Gardens, parks, school gardens, residential areas, farms, parking and other public areas.							
Active Night: Built-in night lowering, the luminaire is automatically dimmed according to. the following intervals. 100% light ~ 21.00 70% light 21: 00 ~ 00: 00 50% light 00: 00 ~ 04: 00 70% light 04: 00 ~ 06: 00 100% light 06.00 ~ The luminaire needs at least 3 days to activate the night lowering.							

Product Data

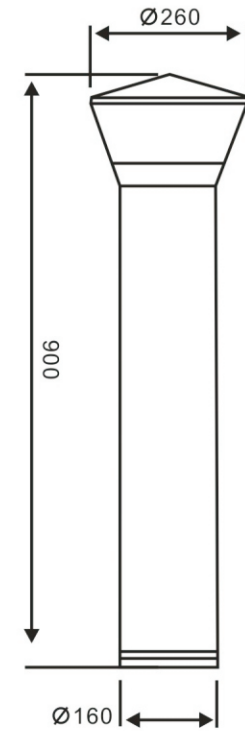

Mounting:	160mm
Weight:	7.8kg
Proj. wind area:	0.338m ²
Torque:	8Nm
Cable length:	5m
Light source: LED CRI:	> 80
Ambient temperature:	- 40°C ~ 40°C
	10% ~ 90% humidity
Protection class:	IP65
Protection class:	I
IK class:	IK10

INSTALLATION

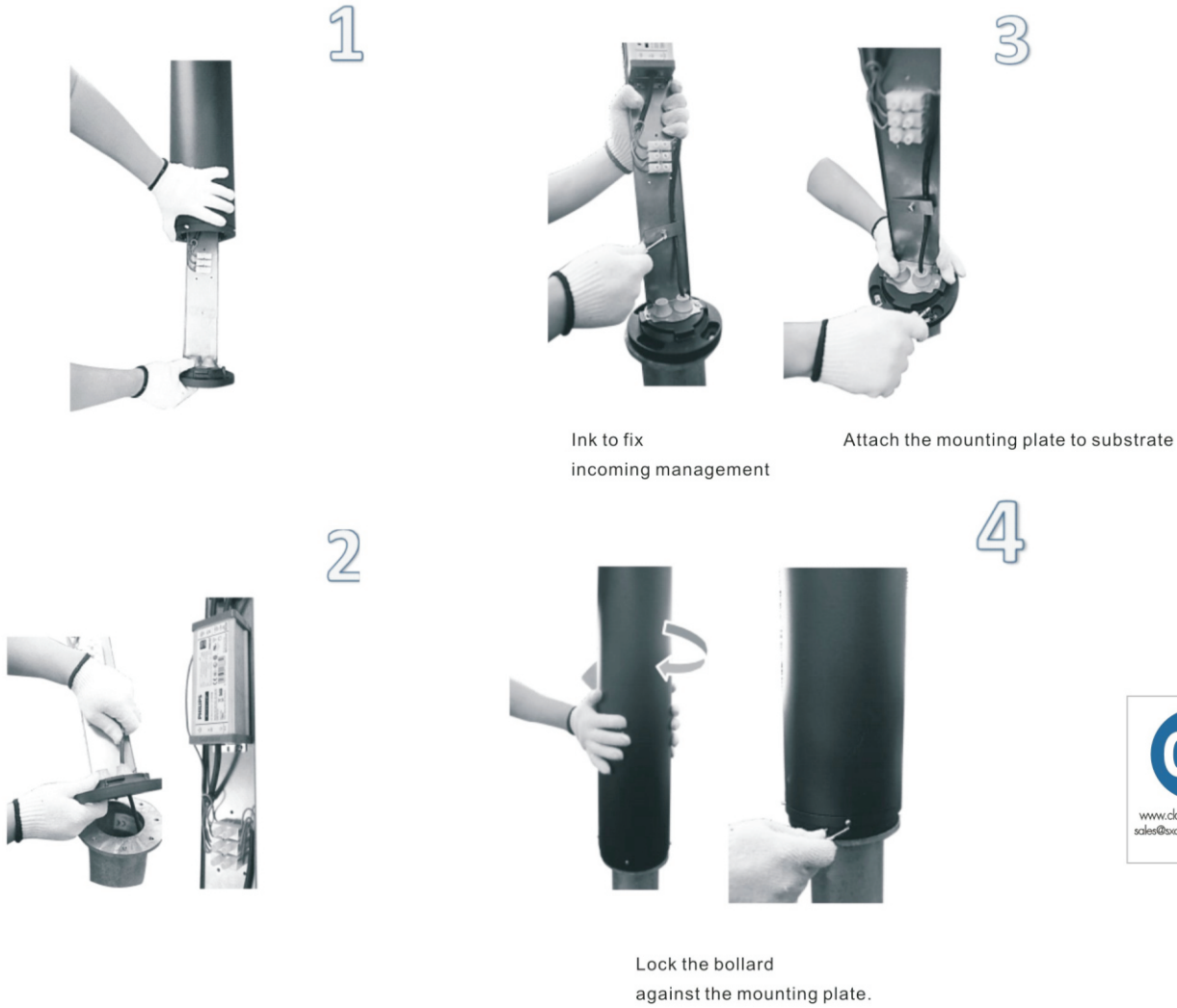

1. The installation must be performed by an electrician.
2. Allen key not supplied, installation must be done by qualified personnel.
3. Power must be turned off before installation.
4. If the connection cable is damaged, it may only be replaced by the manufacturer or service agent appointed by the manufacturer.
5. The light source in this luminaire may only be replaced by the manufacturer or the manufacturer appointed service agent.

Cleaning / Maintenance

It is important to regularly clean the luminaire for optimum lighting and longevity. The luminaire is cleaned with a soft cloth and a mild liquid detergent and water with a max. temperature of 60°C. Never use detergents that contain abrasives or solvents. The luminaire is cleaned in a powerless state. Electrical components and connections shall not exposed to water or moisture. Products marked with this symbol should at the end of their life always delivered to a recycling station. The luminaire is covered by Directive 2012/19 / EU (Waste Electrical and Electronic Equipment)- WEEE).

